



3-PIECE COALING TOWER BUILDING KIT

Congratulations on your purchase of Lionel's 3-piece coaling tower building kit. This kit includes a coaling tower, a hopper shed and a work house. These buildings are a well-known symbol of industrialized America and will help to enhance the authenticity of any train layout.

All of the components, which make up this kit, have been removed from their runners, but some flashing may be present. A sharp hobby knife or a pair of side cutters would be best for removal of this excess material.

Before gluing the parts in place, try assembling them without glue. If the fit is not right, check to make sure you have the proper orientation of the piece. Be aware that some of the pieces have been keyed, so holes for ladders and walls are aligned properly. (Glue is not included with this kit.)

Glue the parts using either a viscous plastic cement or a plastic solvent applied with a fine paintbrush. Use glue sparingly, but if you do get glue on a visible surface, wait until the affected part is entirely dry, then smooth the surface with a file, and finally polish with brass polish. This should help to reduce the damage.

We hope that you enjoy making this kit as much as we enjoyed designing it. If you should have any problems or comments, please let us know.

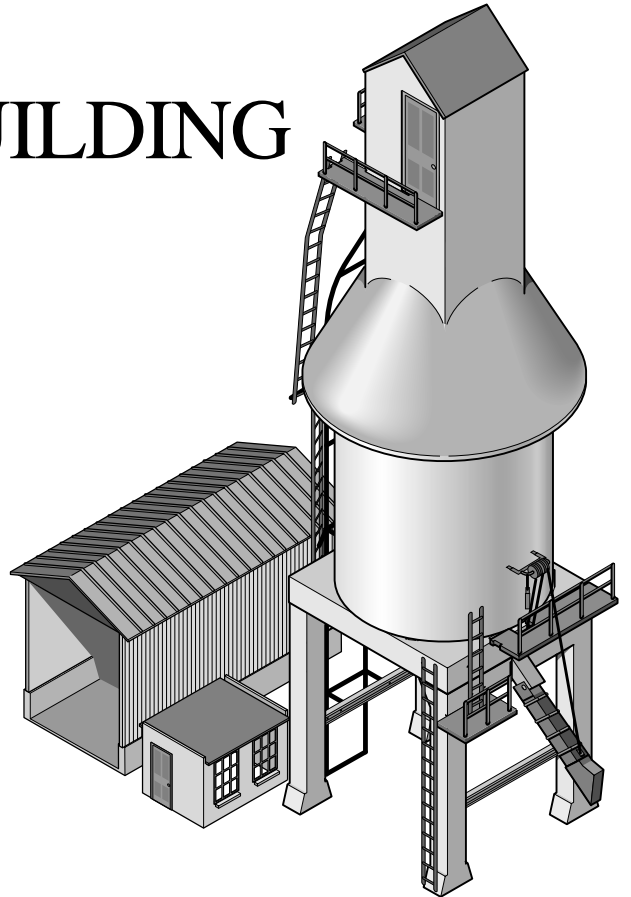

Let's begin assembly of the three structures with the Work House. Glue the four windows (2), into the wall structure (1). Next glue the door (4), into the wall structure (1), and lastly fasten the roof (3) onto the top to complete the Work House

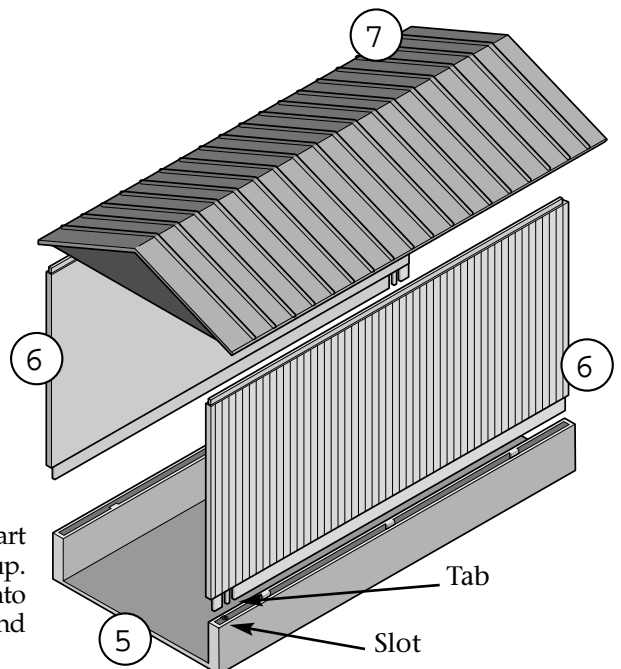
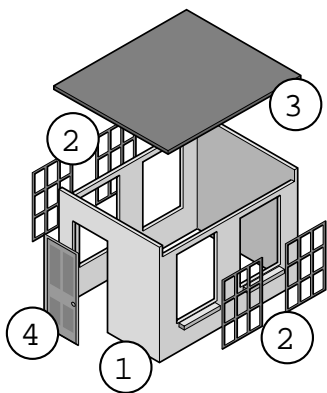

OK, now let's begin assembly of the Hopper Shed. Place part number (5) on a level surface with the foundation walls up. Locate the two walls (6) and notice that they have tabs that fit into the hole on the foundation walls, glue them to the foundation and then glue the roof (7) to the top of the assembled walls.

Coal Tower Assembly

Start construction of the coaling tower by test fitting all the parts shown on this page. This kit has been engineered with many of the parts being "keyed" so they can assemble only one way. (Unless you push really, really hard). We have given you a hint when the parts are keyed, just look for this (✱) symbol and take extra care at this assembly point and all will go well.

Glue part (9) to the top of part (10), there is a key here so make sure the tab on (10) fits into the slot on (9). Next glue part (21) to part (9) with the two notches facing to the left of the door opening, then add the railing (22) to part (21). Glue part (18) to the slot on the other side of part (9) and add the railing (17) to part (18) after it has dried. Last but not least, glue the door (14) into the opening on (9) and glue the roof (8) to the top of (9) and step 1 is finished

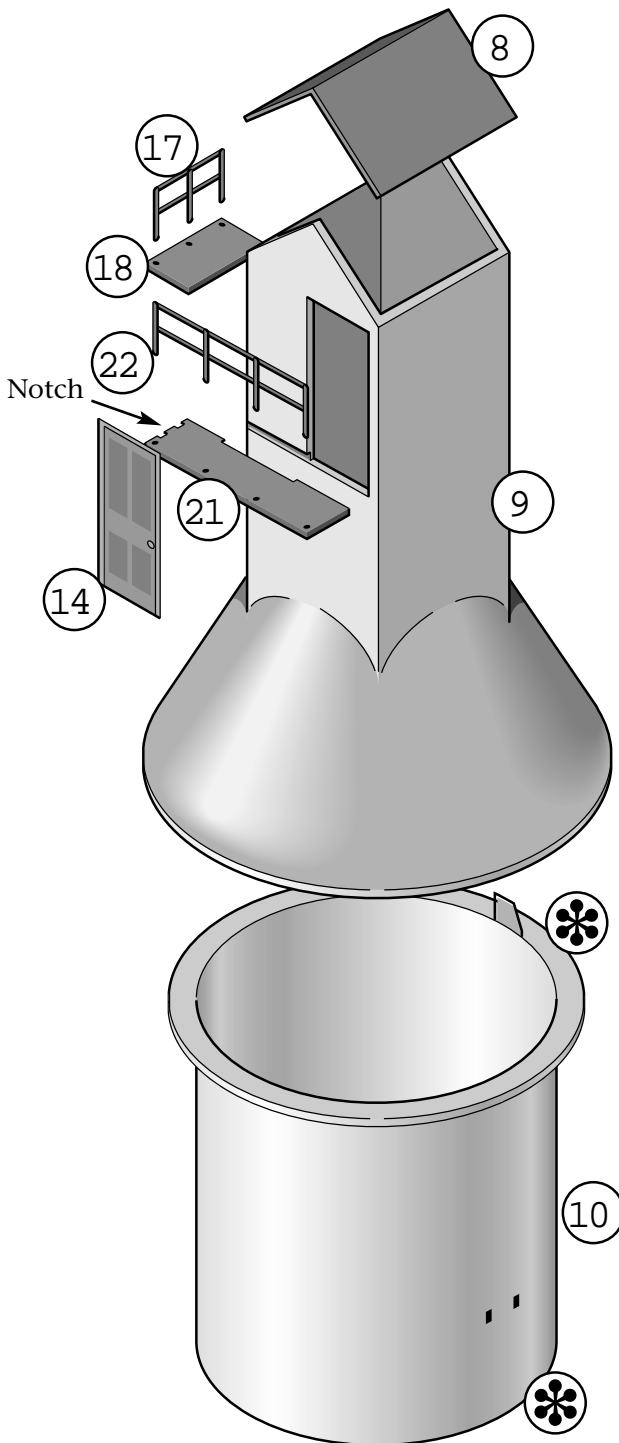

Coal Tower Assembly

Start construction of the Coal Tower Assembly part #2 by test fitting all the parts shown on this page. Begin by fitting the legs part (12) and (11) into the base (13). The legs are keyed to fit only one way. (*) The notch on part (11) fits into (13) on the face that has the indentations for the platform and coal chute. Now glue part (15) onto (13) with the notch located in the middle of (13). There are pins on the bottom of (15) that fit into holes on (13) as an aid in locating its position. Next glue the railing (16) onto platform (15). Assemble platform (19) to the left side of (11) and then install the railing (20) to the platform (19). Glue ladder (31) to (11) pins facing part (11). As the final step, glue the Coal Tower Assembly part #1 to (13) making sure the notches fit together. This assembly is keyed to fit only one way. (*)

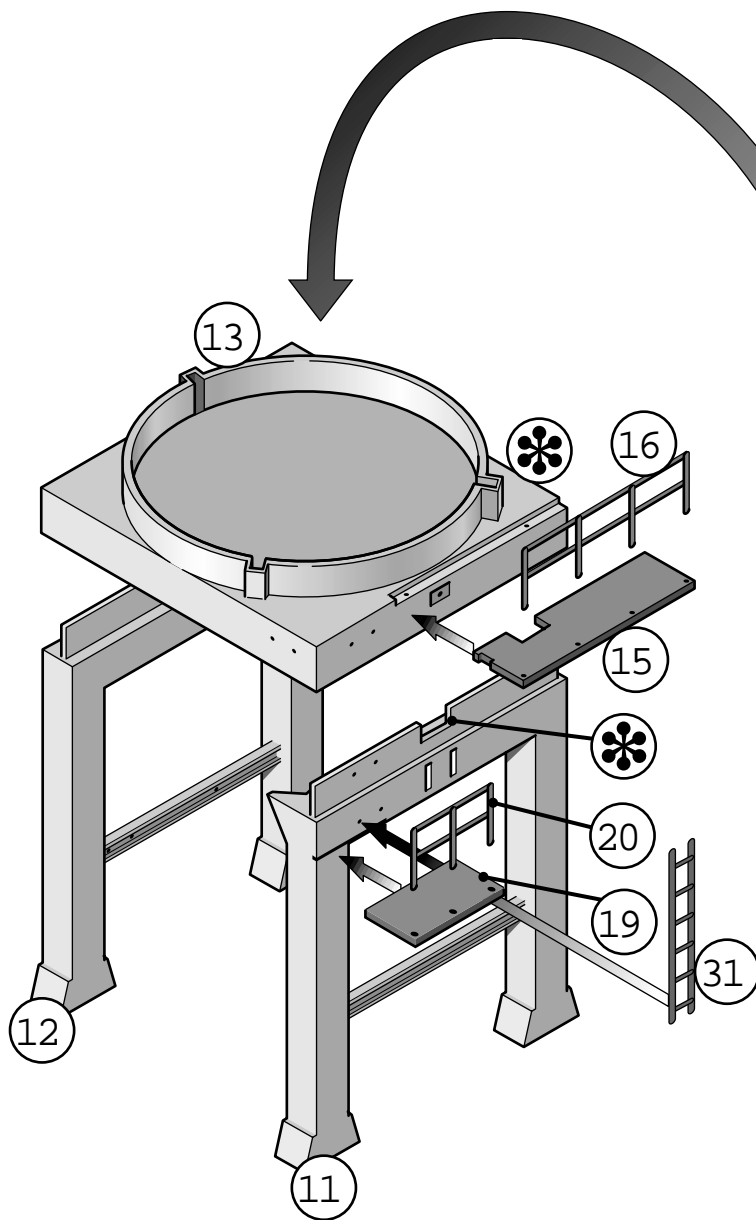

Coal Tower Assembly

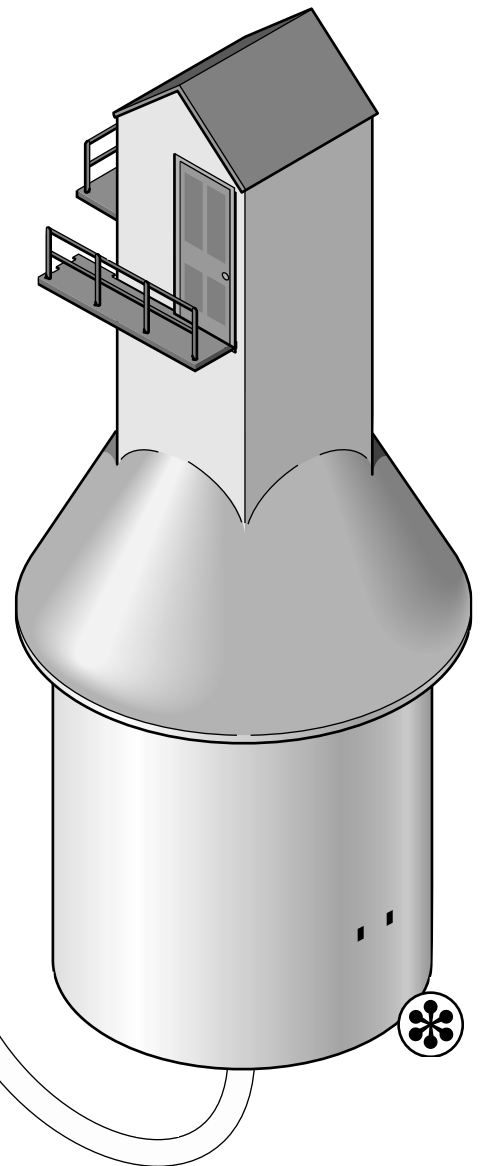

Start construction of the Coaling Tower Assembly part #3 by test fitting all the parts shown on this page. Now lets begin by gluing the coaling rails (29) onto the holes that are on the brace on part (12), the back of (13), and (10). Because of the keys engineered into your kit, these holes should all line up. When you install (29), fit the top of it into the large cavity molded into the top of part (9). Now install the ladder (32) onto (29) as shown and then glue it to the notches on the end of platform (21). Next, glue the ladder (30) onto the support legs on (29), and finish this step by fixing the ladder (33) to the side of parts (11) and (13).

Coal Tower Assembly

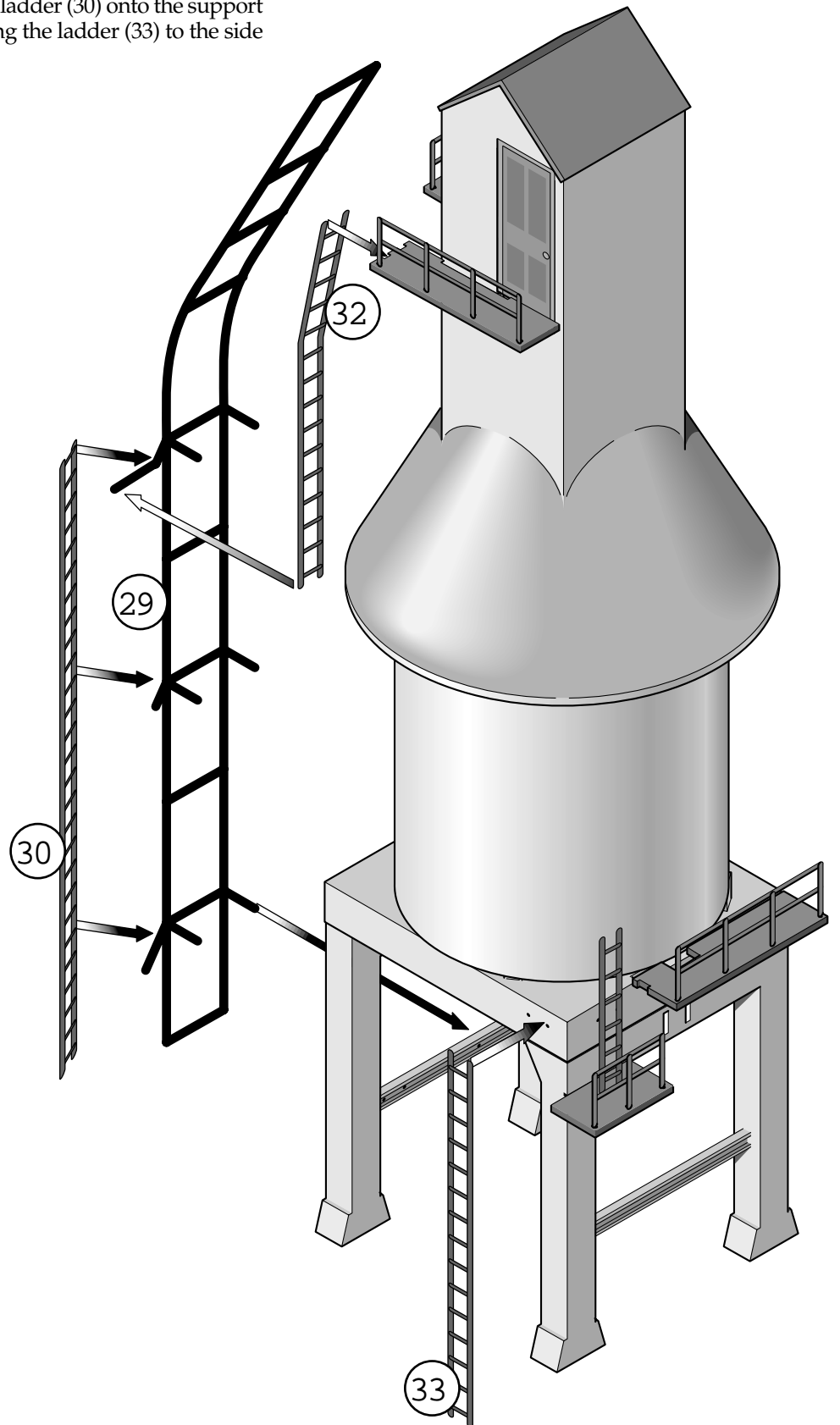

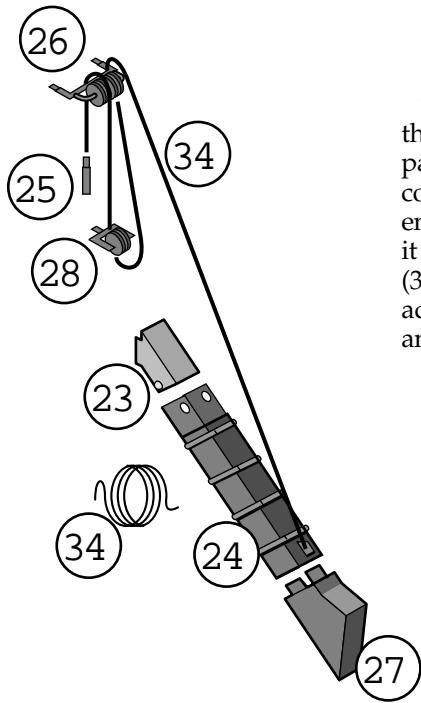

Start construction of the Coaling Tower Assembly part #4 by test fitting all the parts shown on this page. Begin by gluing the fixed coaling chute hinge part (23) to the notches found on (13), then carefully spread the sides of the coal chute (24) over the pins on (23) so it can move freely. Now glue the chute end (27) onto the end of (24). Take part (26), which is the dual pulley, and glue it to the holes on part (9). Glue the single pulley to part (13), and then tie string (34) to the tab on (24), thread the string as shown on the left and below, then add the counterweight (25) to the end of string (34). You may glue the string and chute in a fixed position, or leave it so you can move it up or down

Coal Tower Assembly

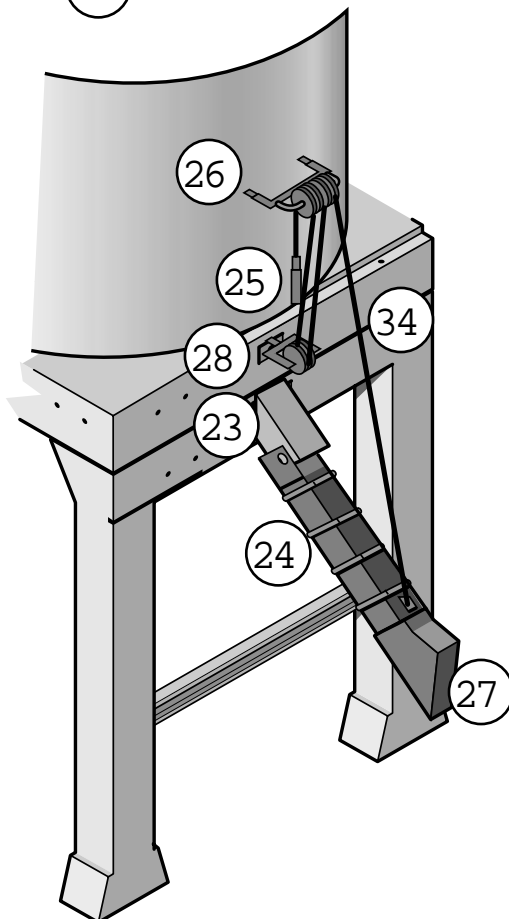

Work House part

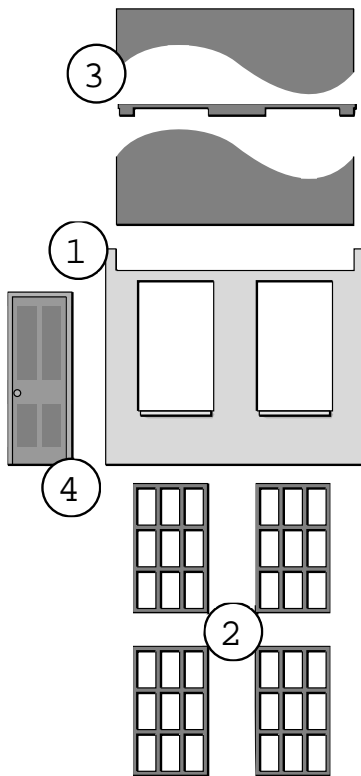

Hopper Shed part

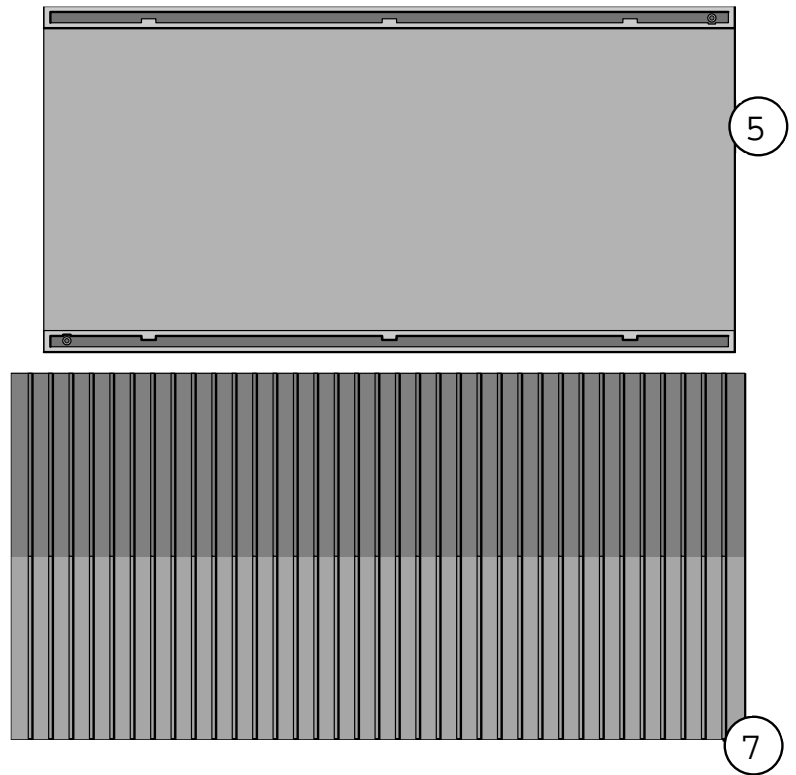

This is a parts labeling diagram. This will help locate parts you need and help in identifying the loose parts.

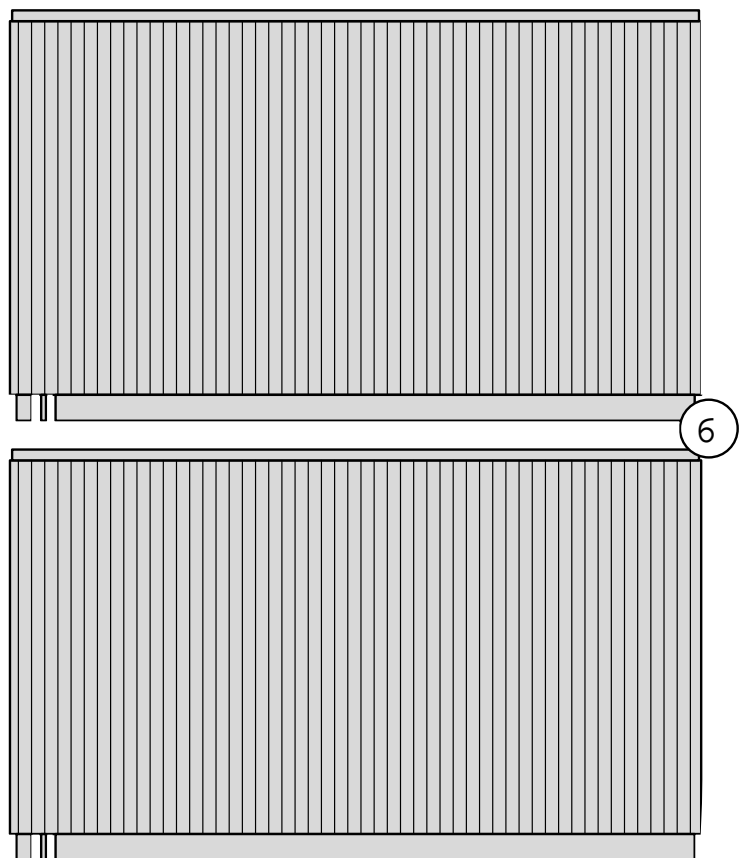

Coaling Tower part

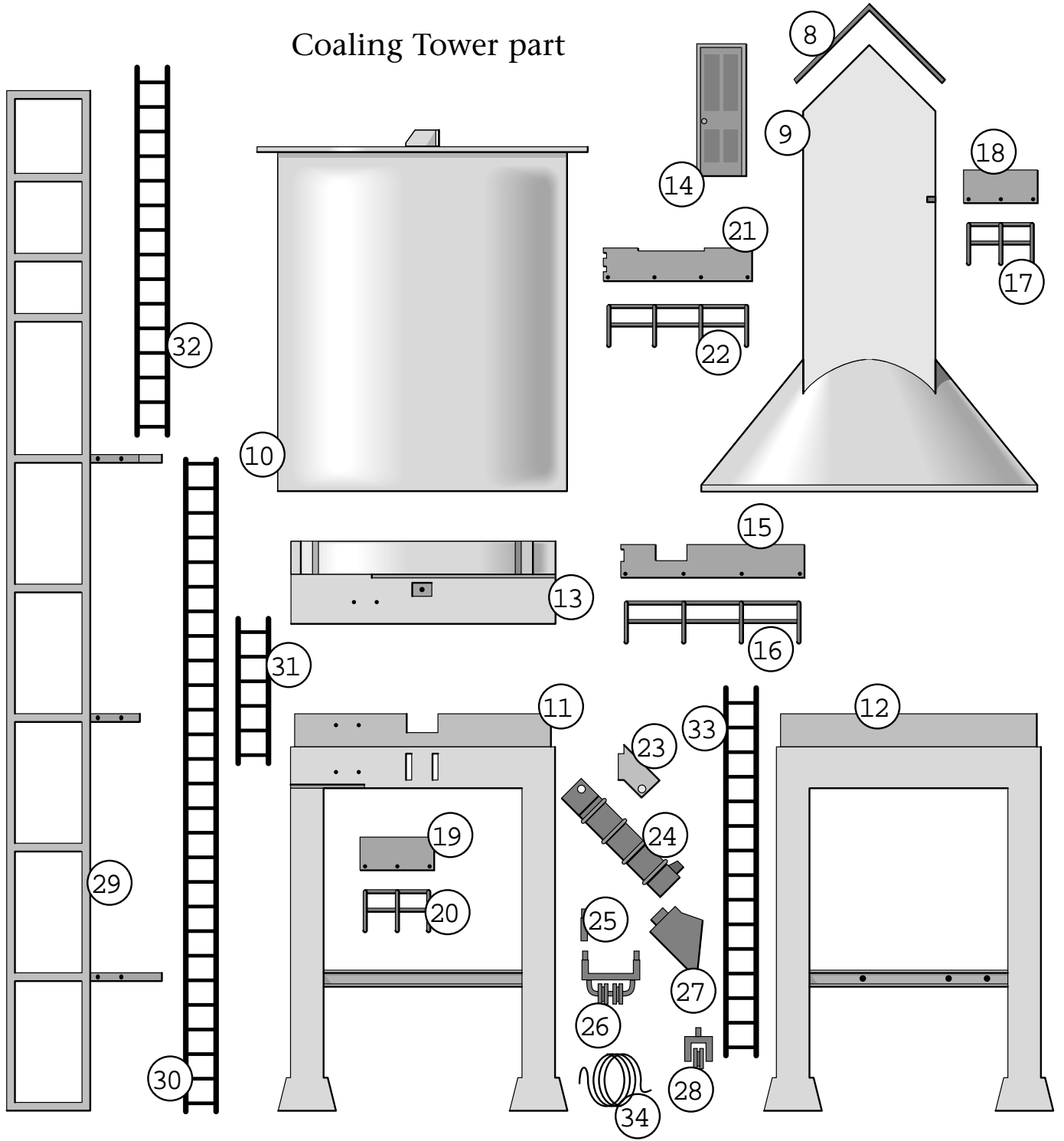

This is a parts labeling diagram. This will help locate parts you need and help in identifying the loose parts.

Limited Warranty/Lionel Service

This Lionel product including all mechanical and electrical components, moving parts, motors and structural components, except for light bulbs, is warranted to the original consumer-purchaser, for one year against original defects in materials or workmanship when purchased through an authorized Lionel merchant.

This warranty does NOT cover normal wear and tear, light bulbs, defects appearing in the course of commercial use, or damage resulting from abuse or misuse of the product by the purchaser. Transfer of this product by the original consumer-purchaser to another person voids this warranty. Modification of this product voids this warranty.

Any warranted product which is defective in original materials or workmanship and is delivered by the original consumer-purchaser to Lionel L.L.C. or an authorized Lionel L.L.C. service center, together with proof of original purchase, will at the option of Lionel L.L.C. be repaired or replaced, without charge for parts or labor. In the event the defective product cannot be repaired, and a replacement is not available, a refund of the original purchase price will be granted. Any products on which warranty service is sought must be sent freight or postage prepaid, as transportation and shipping charges are not covered by the warranty.

IN NO EVENT SHALL LIONEL L.L.C. BE LIABLE FOR INCIDENTAL OR CONSEQUENTIAL DAMAGES.

Some states do not allow the exclusion or limitation of incidental or consequential damages, so the above exclusion may not apply to you. This limited warranty gives you specific legal rights, and you may have other rights which vary from state to state.

INSTRUCTIONS FOR OBTAINING SERVICE

If service for this Lionel L.L.C. product is required, bring the item, along with your dated sales receipt and completed warranty information to the nearest Authorized Lionel Service

Center. Your nearest Lionel Service Center can be found by calling 1-800-4-Lionel, or by contacting our Website @ www.Lionel.com

If you prefer to send it back to Lionel L.L.C. for factory repair, you must first call 810-949-4100 or FAX 810-949-5429 or write to Customer Service, P.O. Box 748 New Baltimore, MI 48047-0748 stating what the item is, when it was purchased and what seems to be the problem. You will be sent a return authorization letter and label to assure your merchandise will be properly handled upon receipt.

Once you have received your return authorization and label, make sure that the item is packed to prevent damage during shipping and handling. We suggest that you use the products original packaging. This shipment must be prepaid and we recommend that it be insured. Please make sure you have followed all of the above instructions carefully before returning any merchandise for service.

You may choose to have your product repaired by one of our Authorized Lionel Service Centers after its warranty has expired. A reasonable service fee will be charged.

WARRANTY INFORMATION

Please complete the information below and keep it, along with your dated sales receipt. You must present this and your dated sales receipt when requesting warranty service.

NAME _____

ADDRESS _____

PLACE OF PURCHASE _____

DATE OF PURCHASE _____

PRODUCT NUMBER _____

PRODUCT DESCRIPTION



LIONEL

© 1998 LIONEL LLC, CHESTERFIELD MI 48051-2493
UNITED STATES OF AMERICA