

JULY 15, 1955

PARTS LIST AND DIAGRAM

AMERICAN FLYER WHISTLE

Model No. 566

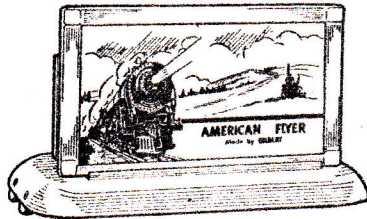

SERVICE INSTRUCTIONS FOR THE No. 566 WHISTLE

The first thing to do is to connect wires from unit and control box, to the transformer and test for operation.

TO CHECK OR REPLACE THE FOLLOWING:

1. SIGN AND SIGN PANEL ASSEMBLY (#24) AND WHISTLE COVER (#26)

- a. Drill out two PA5601 Rivets (#22) and remove PA10670 Sign Panel (#24)
- b. Straighten out lugs on Whistle Cover Assembly (#26) and separate from base (#13)

BASE (#13)

- a. Remove two S45 Screws (#14) and take off PA-9791 Spacer (#18), and N14 Nuts (#23) Follow step b. of #1

TROUBLE IN THE MOTOR, YOU CAN MAKE THE FOLLOWING CHECKS:

- a. Inspect brushes for wear or poor contact and brush springs for proper tension.

- b. Clean or polish commutator on Armature Assembly (#4). If motor is still running slow, the armature may need replacing.

- c. Check to see if motor is oiled and not binding.

IF THESE INITIAL STEPS DO NOT CORRECT THE TROUBLE, IT WILL BE NECESSARY TO DISASSEMBLE THE MOTOR UNIT AS FOLLOWS:

- a. Take off two Brush Caps (#10) and remove Brush Springs (#9) and Brushes (#8)
- b. Remove seven S279 Screws (#1) and take off top Cover Plate (#2) with Bushing (#2-A) and Gasket (#3)
- c. Pull out Armature Assembly (#4)
- d. Remove two Screws (#12), Washers (#11) and Terminal (#19) to take off Brush Bracket Assembly (#7)
- e. Take off Magnet Assembly (#6)
- f. Remove five S279 Screws (#1) and take off Bottom Plate (#17) and Gasket (#16) to replace Whistle Housing (#5)

THE A. C. GILBERT COMPANY
NEW HAVEN 6, CONN., U.S.A.



Printed in U.S.A.

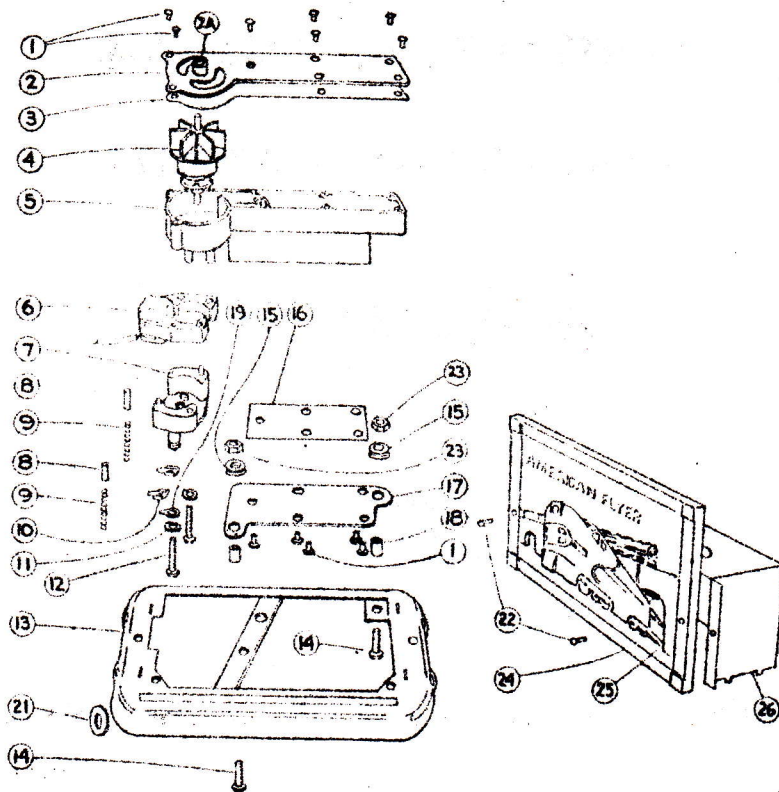

AMERICAN FLYER WHISTLE MODEL No. 566

Diagram Number	Part No.	Description	Price
1	S279	Screw	.01 ea.
2	PA9427	Top Cover Plate	.09 "
2-A	PA9575	Worm Bushing	.05 "
3	PA9428	Top Cover Gasket	.04 "
4	XA9431	Armature Assy.	1.75 "
5	PA9426	Whistle Housing	1.00 "
6	XA9434	Field Assembly	.75 "
	P6095-B	Varnished Cambric Sleeve	.02 "
7	XA12B137	Brush Bracket	.50 "
8	PA9603-A	Brush	.15 "
9	PA10757	Spring	.05 "
10	PA10754	Brush Cap	.02 "
11	W29	Lock Washer	.01 "
12	S20	Screw	.10 dz.
13	XA9193RP	Base Assembly	.74 ea.
14	S45	Screw	.10 dz.
15	PA4356	Rubber Grommet	.02 ea.
16	PA9430	Bottom Cover Gasket	.04 "
17	PA9429	Bottom Cover Plate	.04 "
18	PA9791	Spacer	.02 "
19	PA6173	Terminal	.02 "
20	XA10961-B	Control Box	.50 "
21	P-558-E	Fiber Washer	.10 dz.
22	PA5601	Rivet	.04 "
23	N14	Nut	.01 ea.
24	PA10670	Sign Panel	.21 "
25	M3314	Sign	.03 "
26	XA9188-A	Whistle Cover Assembly	.47 "

NOTE

ALL PARTS PRICES
PRIOR TO FEB. 27, 1958
ARE SUBJECT TO 10%
INCREASE FROM PRICES
SHOWN ON SHEET.