

# #282 4-6-2 ( Pacific ) Chicago & NorthWestern - Tender Diagram

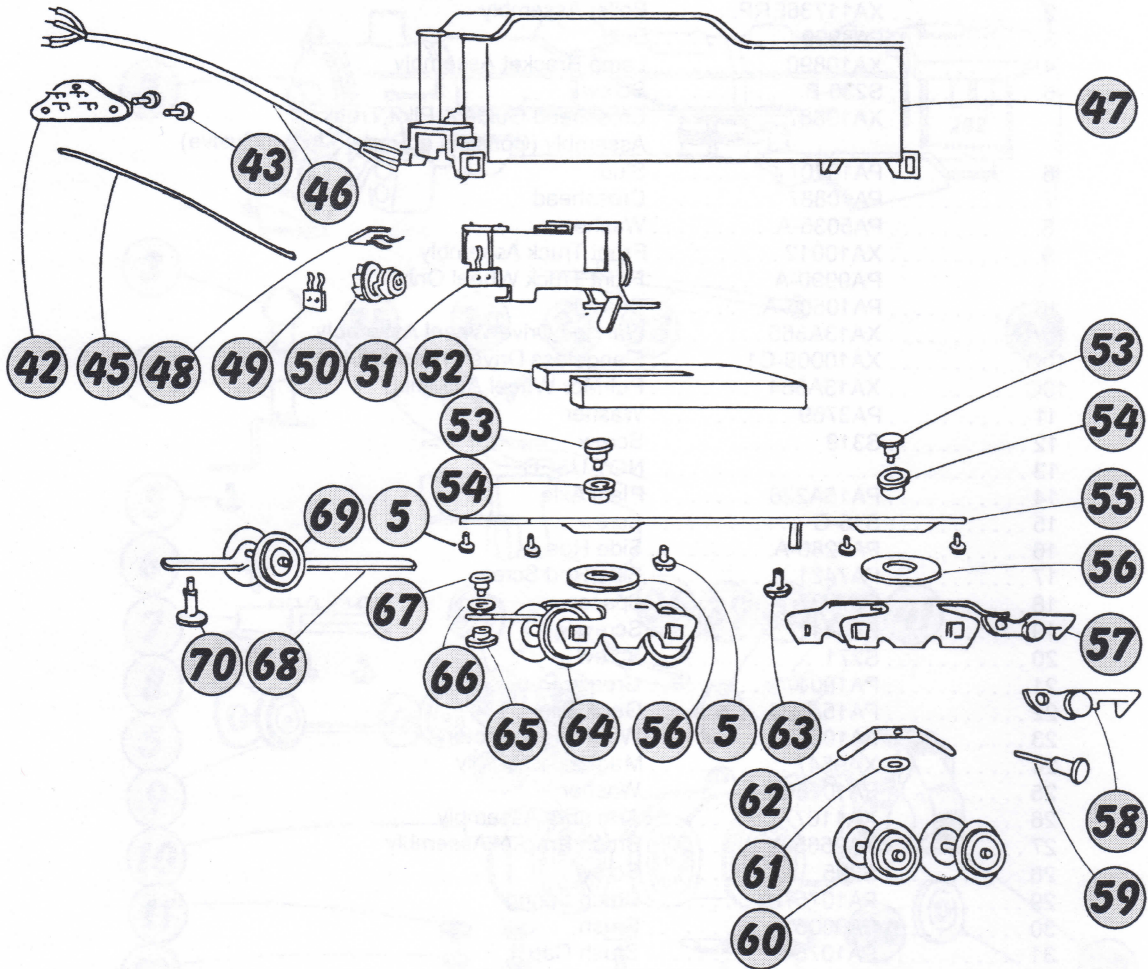

## #282 Locomotive Wiring

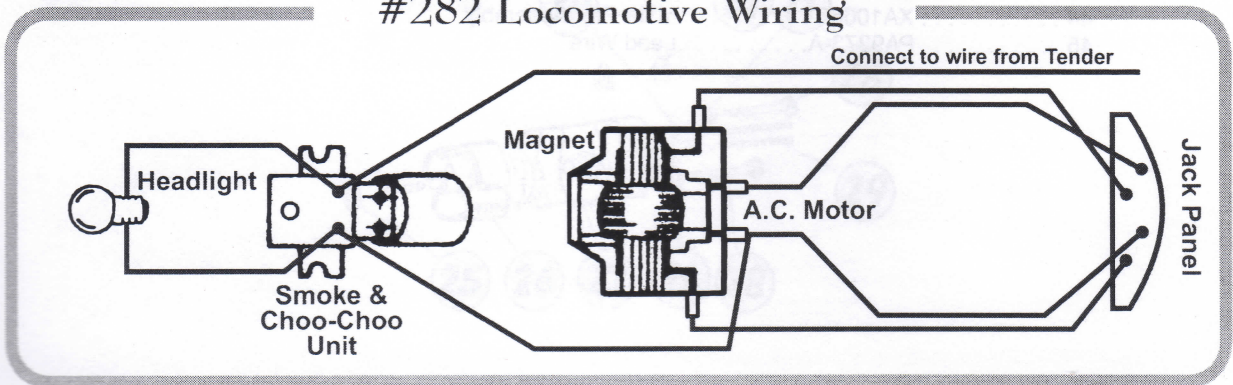



## #282 4-6-2 (Pacific) Chicago & NorthWestern - Tender Parts List

Number ..... Part Number .... Part Description

46	PA13A208A	4 Conductor Cable (Plastic)
47		Tender Body - Obsolete - No Longer Available - No Substitution
48	XA9612-CRP	Top Finger Unit
49	XA9612-BRP	Bottom Finger Unit
50	XA8716	Drum
51	XA10587-E	Remote Control Unit
52	PA10593	Tender Weight
53	PA10235-A	Truck Rivet
54	PA10209	Insulating Bushing
55		Tender Chassis - Obsolete - No Longer Available - No Substitution
56	PA8715-B	Insulating Washer
57	XA12A050-B	Rear Truck Assembly w/Knuckle Coupler Substitute for XA11582 Obsolete
58		Coupler & Weight Assembly - Obsolete
59		Coupler Pin - Obsolete -
60	XA10238	Wheel & Axle Assembly
	PA10140	Metal Wheel
	PA9990	Plastic Wheel
	PA10238	Axle
61	PA1405	Tin Washer
62	PA10207	Contact Spring
63	S184	Screw
64	XA15B800	Front Truck Assembly Substitute for XA11582-A - Obsolete -
65	PA1312	Bushing
66	PA1067-A	Washer
67	PA10751	Stud
68	XA15A784	Draw Bar Assembly Used w/XA15B800 Truck Assembly
	XA10891	Coupler & Yoke Assembly Used Only w/XA11582A Front Truck Assembly
69	PA10019-A	Rear Truck Wheel Only
70	PA4939	Truck Stud

### #282 Tender Wiring

